

**Aeon Series  
AEP126**

**Features**

This 18" diameter combination metal/acrylic mono-point pendant includes a 6' black easily adjustable cord with a twist lock strain relief. Acrylic and spun metal cone are encased in a clear acrylic cone. Acrylic cone can be raised for easy relamping. Pendant has a partially enclosed bottom for easy access. Overall height of the product is 8.5". Product can be used over counter areas and kitchens. Canopy mounts to standard junction box (not included).

**Construction**

Cone fitter is 20-gauge-spun steel. Acrylic diffuser assembly is supported with an internal 18-gauge steel web. Canopy is 5 1/2" in diameter and fits over a standard junction box and is retained with two screws. Power supply connections must be made inside a junction box (not included).

**Finish**

All exposed metal parts are plated satin nickel with clear lacquer topcoat.

**Diffuser**

Diffuser is .125" thick vacuum-formed white acrylic with a clear .125" thick vacuum-formed outer domed diffuser.

**Electrical**

This unit is wired with a line voltage socket for 1/26 watt self-ballasted spring lamp GU24 base; 120V/60 Hz AC operation.

**Lamping**

For use with 1/26 watt self ballasted 2700K spring lamp included.

**Certification**

All fixtures are cULus listed for damp locations.

**Options**

- 13 or 18 watt GU24 lamping
- Dimming
- ENERGY STAR qualified

Specifications and dimensions  
subject to change without notice.

Project _____		Fixture Type _____
Location _____		Quantity _____
Approved By _____	Date _____	Catalog Number _____

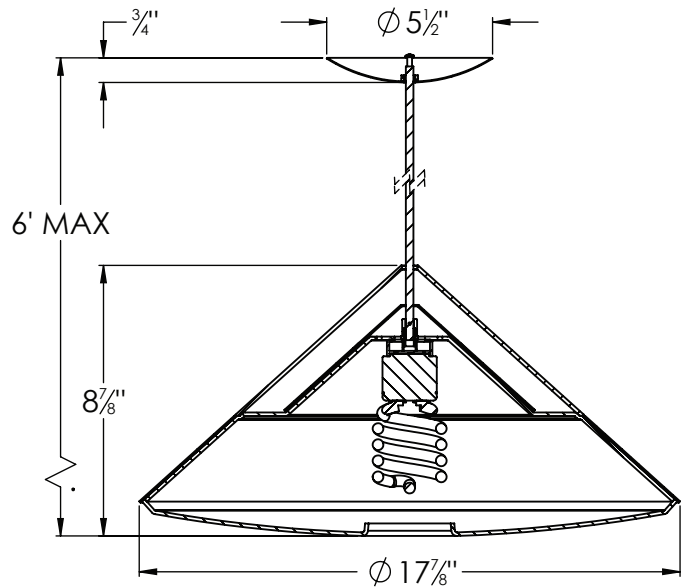

**Ordering Information:**

Model No.	Lamps		Dimensions		
	Finish	120V	Qty	Lamp	H
Satin Aluminum	AEP126SASCT	1	26W MAX GU24 SELF-BALLAST CFL	8-7/8"	17-7/8"