

DESCRIPTION

These white cloud fixtures have a box-style shape with rounded edges and corners for a softer appearance. Available in seven sizes, two 2-foot square models, two 4-foot by 1-foot models, one 4-foot by 2-foot model, and two 4-foot square models.

CONSTRUCTION

Housing and cover are die formed of 22 gauge cold rolled steel, and corners are spot welded for rigidity. Standard mounting holes and standard wiring knockouts are included.

FINISH

Housing interior is finished in lighting grade white baked gloss enamel paint. Exterior is available in white or black baked gloss enamel.

DIFFUSER

Lens is made from a sheet of cast translucent white 100% virgin acrylic, .125" thick, formed into a reverse square cloud with a stipple finish interior and a smooth finish exterior. Four steel clips on two edges of the diffuser allow it to lift and shift onto the housing lip.

ELECTRICAL

All units with model numbers ending in ES are wired with U.L. listed high power factor, rapid start, Class P, energy saving (ES) full light output, E ballasts, for 120 volt, 60 hertz A.C. operation.

All non-rapid start units have trigger start, normal power factor ballasts. Lamp holders are rotating. Lampholders are rotating lock, medium bi-pin type. All fixtures are U.L. listed.

OPTIONS

For ballast upgrades and options, refer to back of guide. Other voltages, listings, and ratings available on request (contact factory).

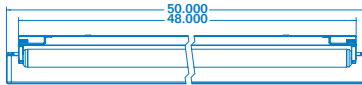
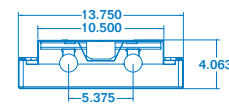

MAR14 & CSW142

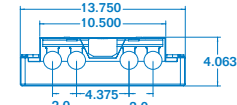

MAR14 & CSW144

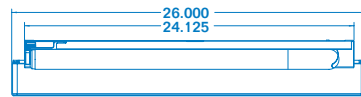
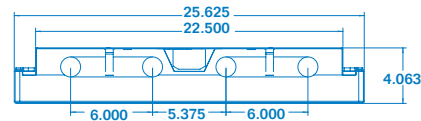

MAR22 & CSW2U4

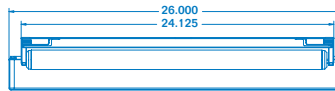
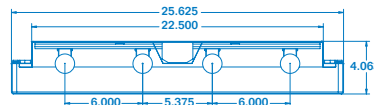

MAR22 & CSW224

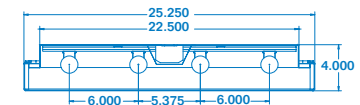

MAR24 & CSW244

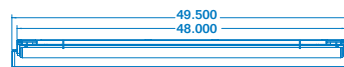
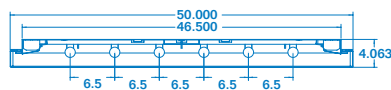

MAR44 & CSW446

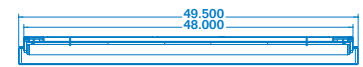
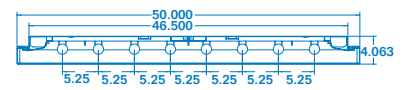

MAR44 & CSW448

ORDERING INFORMATION

Model No			DIMENSIONS				
White Diffuser	White Housing	Fluorescent Lamps	L	W	D	Mtg. Ill.	
MAR14	CSW142ES	(2) T12 48"	50"	13 $\frac{3}{4}$ "	4 $\frac{1}{16}$ "	55	
MAR14	CSW144ES	(4) T12 48"	50"	13 $\frac{3}{4}$ "	4 $\frac{1}{16}$ "	55	
MAR22	CSW224	(4) T12 24"	26"	25 $\frac{5}{8}$ "	4 $\frac{1}{16}$ "	56	
MAR22	CSW2U4ES	(2) T12 6" U	26"	25 $\frac{5}{8}$ "	4 $\frac{1}{16}$ "	56	
MAR24	CSW244ES	(4) T12 48"	50"	25 $\frac{1}{4}$ "	4"	57	
MAR44	CSW446ES	(6) T12 48"	49 $\frac{1}{2}$ "	50"	4 $\frac{1}{16}$ "	58	
MAR44	CSW448ES	(8) T12 48"	49 $\frac{1}{2}$ "	50"	4 $\frac{1}{16}$ "	58	