

TL/TLI/TLE SERIES

DESCRIPTION

The TL, TLI and TLE Series are a low profile under-cabinet light. They feature a one inch deep profile and come in 5 different lengths, 12", 21", 24", 33" and 42". All series use T5 fluorescent lamps. The difference between the series' is the ballast used. The TL Series uses a magnetic preheat low power factor ballast, the TLI Series uses a magnetic ballast with electronic starter, while the TLE Series uses a fully electronic instant start ballast. Both the TLI and TLE offer virtually no noise operation, and they run 60% cooler than conventional preheat ballasts.

CONSTRUCTION

Housing die formed of 21 gauge steel, cover die formed of 24 gauge steel. Standard mounting holes and standard wiring knockouts are included. Reducer/coupler for hardware electrical connection is die cast aluminum. Can be mounted individually or in continuous runs.

FINISH

The interior of both series is finished in lighting grade white baked gloss enamel paint. TLI & TLE exterior is also finished in lighting grade white baked gloss enamel paint. TL Series exterior has two options, a lighting grade white baked gloss enamel paint, or a hot stamped oak woodgrain finish.

DIFFUSER

The one-piece lens is extruded of translucent white 100% virgin acrylic, with a linear ribbed prism pattern on the outside surface. Thickness is .080". Lens snaps into the housing.

ELECTRICAL

All units are wired with U.L. listed normal power factor, Class P ballasts for 120 volt, 60 hertz A.C. operation. The TL ballasts are magnetic preheat. The TLI ballasts are magnetic with electronic starter. The TLE ballasts are electronic instant start. Lampholders are rotating lock, mini bi-pin type. A direct wire U.L. listed connector is included and is suitable for 3/8-inch flexible conduit or 3 wire Romex. All fixtures are U.L. listed.

OPTIONS

Fixture is available with a convenience outlet (CO), rocker on/off switch (R), power cord (X015), or lamp included (T). Contact factory for configurations. For ballast upgrades and options, refer to back of guide. Other voltages, listings, and ratings available on request (contact factory).

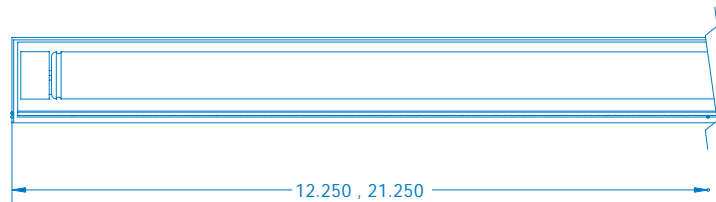
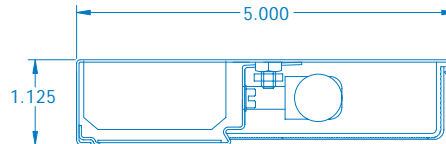
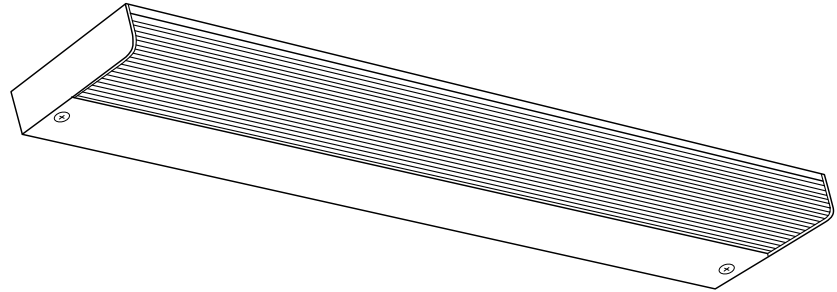

TL/TLI/TLE108, 113

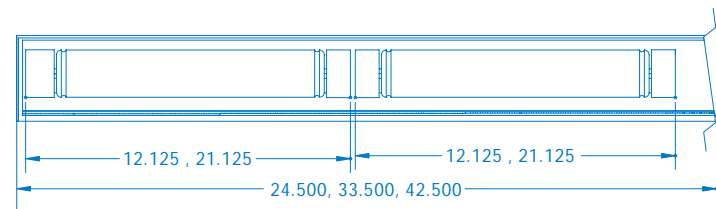
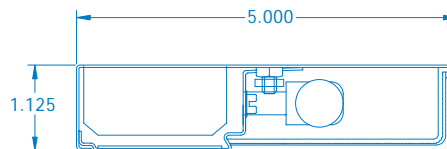

TL/TLI/TLE 208, 138, 213

ORDERING INFORMATION

Model No.						DIMENSIONS			
TL Series	TL Series	TLI Series	TLE Series	Fluorescent Lamps		L	W	D	Mtg. Ill.
White	Oak	White	White	(1)	8 watt 12" T5 Lamp	12¼"	5"	1⅞"	78
TL108	TL108K	TLI108	TLE108	(1)	13 watt 21" T5 Lamp	21¼"	5"	1⅞"	75
TL113	TL113K	TLI113	TLE113	(2)	8 watt 12" T5 Lamps	24½"	5"	1⅞"	78
TL208	TL208K	TLI208	TLE208	(1)	8 watt 12" & (1) 13 watt 21" T5 Lamp	33½"	5"	1⅞"	77
TL138	TL138K	TLI138	TLE138	(2)	13 watt 21" T5 Lamps	42½"	5"	1⅞"	76
TL213	TL213K	TLI213	TLE213						