

# T5 H.O. Fluorescent 4- and 6-Lamp Hi-Bay Fixtures

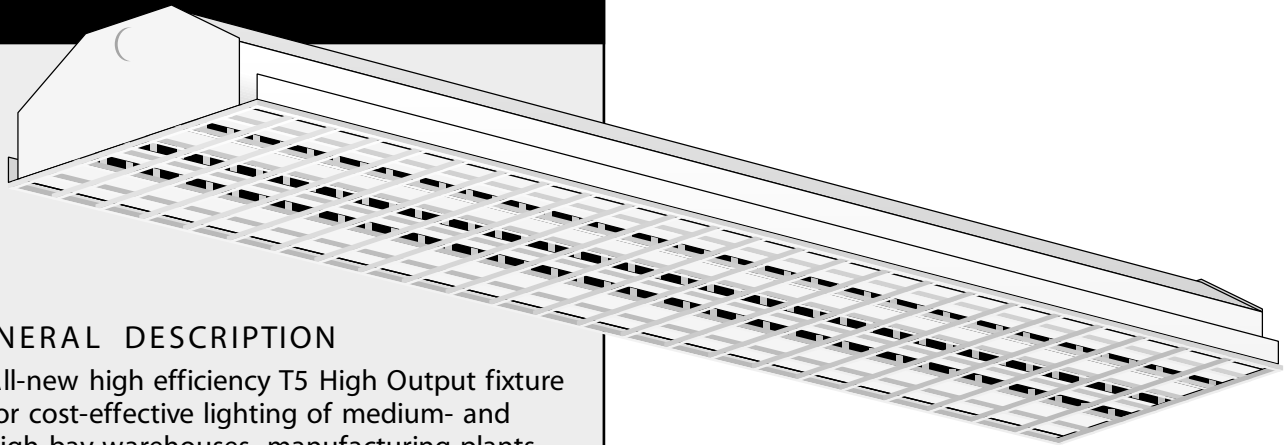

## GENERAL DESCRIPTION

All-new high efficiency T5 High Output fixture for cost-effective lighting of medium- and high-bay warehouses, manufacturing plants, sports facilities and retail spaces.

New Engineered Lighting™ design features precision-formed beveled Miro 4™ reflector to achieve maximum light output.

Delivers either 19,000+ lumens from four economical 54-watt H.O. lamps, or 31,000+ lumens from six lamps; replaces H.I.D. fixtures on a one-for-one basis. Surface, pendant, chain or stem mount.

Optional wireguard with innovative fastener design allows easy lamp access.

Highest quality materials and workmanship. Union made in the U.S.A.

## SPECIFICATIONS

**Housing:** Die-formed heavy-gauge cold rolled steel.

**Finish:** Post-painted white housing with Miro 4™ anodized reflector.

**Ballast Access:** Ballasts are accessible by removal of socket-plate screws. Reflector swings out on hinged ends.

**Ballasts:** U.L. listed, Class P, Electronic, 120-277 volt 50/60 Hz ballasts for T5 H.O. lamps, 0°F start.

**Lampholders:** G5 push-through sockets for F54/T5HO lamps.

**Mounting:** Fixtures designed for surface, pendant, stem or chain hanging.

**Wireguard (WG optional):** Combination 6 and 9 ga. wire (A.W.G. Standard) with white powder-coat finish. Attaches with clips for easy lamp access.

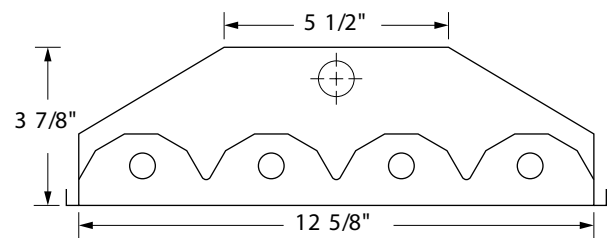

4-Lamp Hi-Bay End View

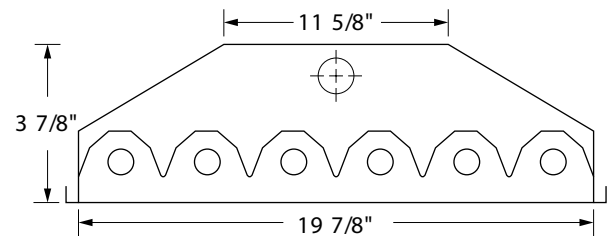

6-Lamp Hi-Bay End View

## ORDERING INFORMATION

Catalog No.	Lamps	Length
HBS454E5	(4) F54/T5HO	48"
HBW454E5	(4) F54/T5HO	48"
HBS654E5	(6) F54/T5HO	48"
HBS654E5WG (with wireguard)	(6) F54/T5HO	48"
HBW654E5	(6) F54/T5HO	48"
HBW654E5WG (with wieguard)	(6) F54/T5HO	48"

### 4-Lamp T5 Hi-Bay With Open Face

12 x 48 High-bay  
Luminaire With Specular  
Reflector, No Wire Grid  
4 54W T5 H.O. Lamps  
(F54/T5HO/835)

TESTING CONDUCTED BY:  
Building Acoustics and  
Lighting Laboratories, Inc.  
DATE: 5/17/02  
REPORT NUMBER: 11529.0

#### Zonal Cavity Coefficients of Utilization

Ceiling	.80				.70				.50			.30			.10			.0
Wall	.70	.50	.30	.10	.70	.50	.30	.10	.50	.30	.10	.50	.30	.10	.50	.30	.10	.00
0	1.17	1.17	1.17	1.17	1.15	1.15	1.15	1.15	1.10	1.10	1.10	1.05	1.05	1.05	1.01	1.01	1.01	.99
1	1.09	1.05	1.02	.99	1.07	1.03	1.00	.97	.99	.96	.94	.95	.93	.91	.92	.90	.88	.87
2	1.01	.94	.88	.83	.99	.92	.87	.82	.89	.84	.81	.86	.82	.79	.83	.80	.77	.75
3	.93	.84	.77	.72	.91	.83	.76	.71	.80	.75	.70	.77	.73	.69	.75	.71	.68	.66
4	.86	.76	.68	.62	.84	.74	.67	.62	.72	.66	.61	.70	.64	.60	.68	.63	.59	.57
5	.79	.68	.60	.54	.77	.67	.59	.53	.65	.58	.53	.63	.57	.52	.61	.56	.52	.50
6	.73	.61	.53	.47	.71	.60	.52	.47	.58	.52	.46	.57	.51	.46	.55	.50	.46	.44
7	.68	.55	.47	.41	.66	.54	.47	.41	.53	.46	.41	.52	.45	.41	.50	.45	.40	.39
8	.62	.50	.42	.36	.61	.49	.41	.36	.48	.41	.36	.47	.40	.36	.45	.40	.35	.34
9	.58	.45	.37	.32	.56	.44	.37	.31	.43	.36	.31	.42	.36	.31	.41	.35	.31	.29
10	.53	.41	.33	.28	.52	.40	.33	.28	.39	.32	.28	.38	.32	.28	.37	.32	.28	.26

RCP

#### Lumen Summary

Zone	Lumens	% Lamp	% Fixt
0-30	6656	33.3	33.7
0-40	10458	52.3	53.0
0-60	16807	84.0	85.2
0-90	19731	98.7	100.0
90-120	0	0.0	0.0
90-130	0	0.0	0.0
90-150	0	0.0	0.0
90-180	0	0.0	0.0
0-180	19731	98.7	100.0

#### IES Spacing Criteria

End = 1.3 Diagonal = 1.3 Cross = 1.2

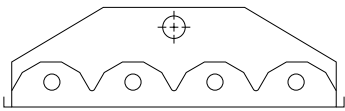

End view showing reflector configuration and placement of lamps.

#### Zonal Lumens

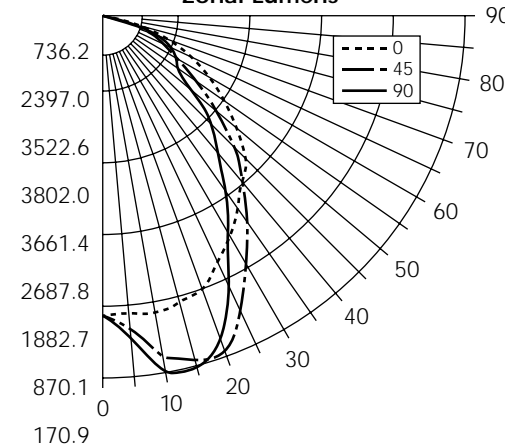

### 6-Lamp T5 Hi-Bay With Open Face

20 x 48 High-bay  
Luminaire With Specular  
Reflector, No Wire Grid  
6 54W T5 H.O. Lamps  
(F54/T5HO/835)

TESTING CONDUCTED BY:  
Building Acoustics and  
Lighting Laboratories, Inc.  
DATE: 9/24/02  
REPORT NUMBER: 11679.0

#### Zonal Cavity Coefficients of Utilization

Ceiling	.80				.70				.50			.30			.10			.0
Wall	.70	.50	.30	.10	.70	.50	.30	.10	.50	.30	.10	.50	.30	.10	.50	.30	.10	.00
0	1.23	1.23	1.23	1.23	1.20	1.20	1.20	1.20	1.15	1.15	1.15	1.10	1.10	1.10	1.06	1.06	1.06	1.03
1	1.15	1.11	1.07	1.04	1.12	1.09	1.05	1.02	1.04	1.02	.99	1.00	.98	.96	.97	.95	.93	.91
2	1.06	.99	.94	.89	1.04	.98	.92	.88	.94	.90	.86	.91	.87	.84	.88	.85	.82	.80
3	.99	.89	.82	.77	.96	.88	.81	.76	.85	.79	.75	.82	.77	.73	.80	.76	.72	.70
4	.91	.80	.73	.67	.89	.79	.72	.66	.77	.70	.65	.74	.69	.64	.72	.68	.64	.62
5	.84	.72	.64	.58	.82	.71	.63	.57	.69	.62	.57	.67	.61	.56	.65	.60	.56	.54
6	.78	.65	.57	.51	.76	.64	.56	.51	.63	.56	.50	.61	.55	.50	.59	.54	.49	.48
7	.72	.59	.51	.45	.70	.58	.50	.45	.57	.50	.45	.55	.49	.44	.54	.48	.44	.42
8	.67	.53	.45	.40	.65	.53	.45	.39	.51	.44	.39	.50	.44	.39	.49	.43	.39	.37
9	.61	.48	.40	.35	.60	.48	.40	.35	.46	.39	.34	.45	.39	.34	.44	.38	.34	.32
10	.57	.44	.36	.31	.56	.43	.36	.31	.42	.35	.31	.41	.35	.31	.40	.35	.30	.29

RCP

#### Lumen Summary

Zone	Lumens	% Lamp	% Fixt
0-30	11090	37.0	35.7
0-40	17185	57.3	55.4
0-60	26838	89.5	86.4
0-90	31046	103.5	100.0
90-120	0	0.0	0.0
90-130	0	0.0	0.0
90-150	0	0.0	0.0
90-180	0	0.0	0.0
0-180	31046	103.5	100.0

#### IES Spacing Criteria

End = 1.3 Diagonal = 1.2 Cross = 1.1

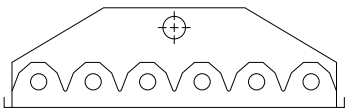

End view showing reflector configuration and placement of lamps.

#### Zonal Lumens

